

INSTALLATION & CARE INSTRUCTIONS



874 Stokeswood Avenue
Atlanta, GA 30316

Phone: (404)-304-0086
Email: drew@fitnessfinishes.com



CONTENTS OF TYPICAL HARDWARE KIT



OTHER MATERIALS REQUIRED FOR INSTALLATION

FOR CONSTRUCTION OF BASE:

2x4's, nails, level, plywood (optional)
material for shims.

FOR UNLOADING LOCKERS:

Hand truck

FOR CUTTING FILLERS, ATTACHING END PANELS & COMPLETING INSTALL:

Drill and 3/32" drill bit
40-60 tooth carbide tipped blade
Measuring tape
Silicon or super glue
Plywood or particle board (to cover void space)

INSTALLATION & CARE INSTRUCTIONS CONT'D.



Thank you for choosing a Fitness Finishes quality locker system. Proper planning will ensure a timely install and an attractive locker room. Please read the following instructions thoroughly and keep this pamphlet available for quick reference. Note: If your job includes keyed or combination locks, you'll find the master keys with your installation guide. These keys allow you access to all lockers, which are locked with the individual keys taped inside. It is important to safeguard these keys. In the event of loss they can be replaced for a small fee by contacting Fitness Finishes directly. One locker is designated as the hardware kit locker and contains important supplies needed for installation. (Labeled with **BRIGHT STICKER** on back of locker)

1. Preparation

Step 1. It is very important to construct the base before the arrival of lockers. Use 2x4s to build a frame with a depth of 17 inches and a width that will allow lockers to hang over by 3" – providing the toe kick. Add cross members every 2' on center. It is extremely important that the base is totally level, this will ensure a professional installation. Add shims until base is level all around. An optional layer of plywood can be applied to base, but is not required.



Screw back panel of locker to wall every 4th or 5th locker unit at 18" from top of locker

Base and locker Frame

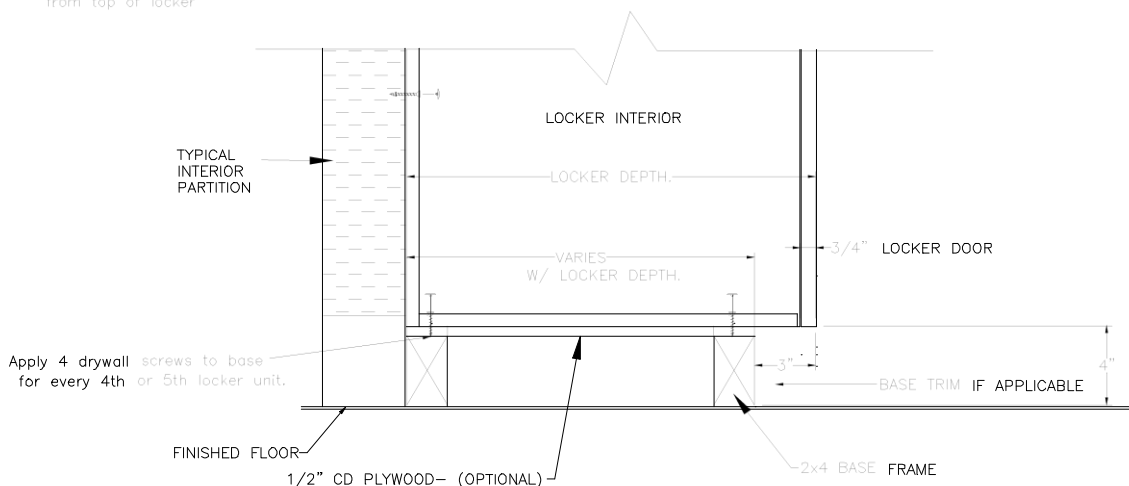

NOTE: After bases are reasonably level, nail to wall only. Do not attach to floor so that base may be shimmed to level lockers. Do not attach one base unit to another.

INSTALLATION & CARE INSTRUCTIONS CONT'D.



2. TYPES OF LOCKER INSTALLATION

Wall attachment. While lockers are in approximate position, adjust them so that Filler Panels of equal widths are at both ends of a row, achieving the centered look. Secure every fourth locker to the wall and base using drywall screws. Apply 1 screw in each back and bottom corner, covering the screw head with an almond cap.

Step 2. Unload lockers with extreme care. Treat lockers, panels, benches, etc. as fine furniture. Arrange for several people to assist in the unloading, keeping in mind that the driver has a schedule to follow and limited time at your facility. If hiring temporaries, supervise such to prevent nicks and other damages. All loads are inspected by Quality Control at Hollman, Inc. before leaving the plant. Using the hand truck, unload the frames one by one, making sure the back or side of the locker is the only point of contact. Proceed to move locker with one hand on the unit for stability. Carry lockers directly to the locker area, setting them into approximate position on the base. Note: Chips in the laminate at the back and sides are unavoidable and will not be visible once lockers are attached together.

Ensure the back or side of the locker is the only point of contact



Do not transport the locker in a front facing position



INSTALLATION & CARE INSTRUCTIONS CONT'D.



END PANELS

End panels are either double (covering 2 rows of lockers back to back) or single (covering a single side of a locker). No end panels are needed when lockers are recessed into a wall. It is recommended to apply a small amount of glue to panel before attaching for extra support. Align panel with locker frame and using drywall screws, drill into end panel through interior of locker. See diagram: locker end panel attachment. Cover with caps.



Drill drywall screw into end panel.



Front view of locker and end panel attachment.

LOCKER END PANEL ATTACHMENT

Step 1+2
Installation
Diagram

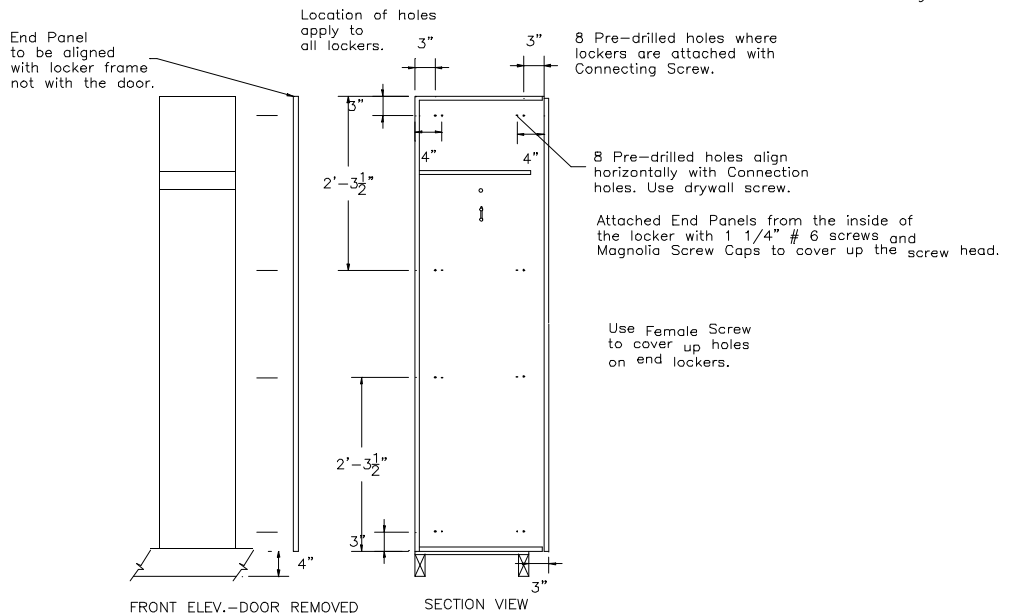

INSTALLATION & CARE INSTRUCTIONS CONT'D.



FILLER AND CORNER PANELS

Use 40-60 tooth carbide tipped blade to obtain the cleanest possible cut. Be sure to cut fillers into equal widths for each end of a row of lockers. Drill through the inside of the locker, just behind the door, into the thin edge of the filler panel. Place caps on all screw heads. To attach filler panel to the wall, work from on top, using a back piece if necessary. See diagram of corner filler panel installation for specific measurements when working on corners. Cut and secure together using drywall screws first, then permanently mount into place by drilling screws into thin edge of filler through each locker frame involved. All corners and fillers should be mounted to fit just behind the edge banding on the side of the locker.



Corner Filler Panel Installation Detail

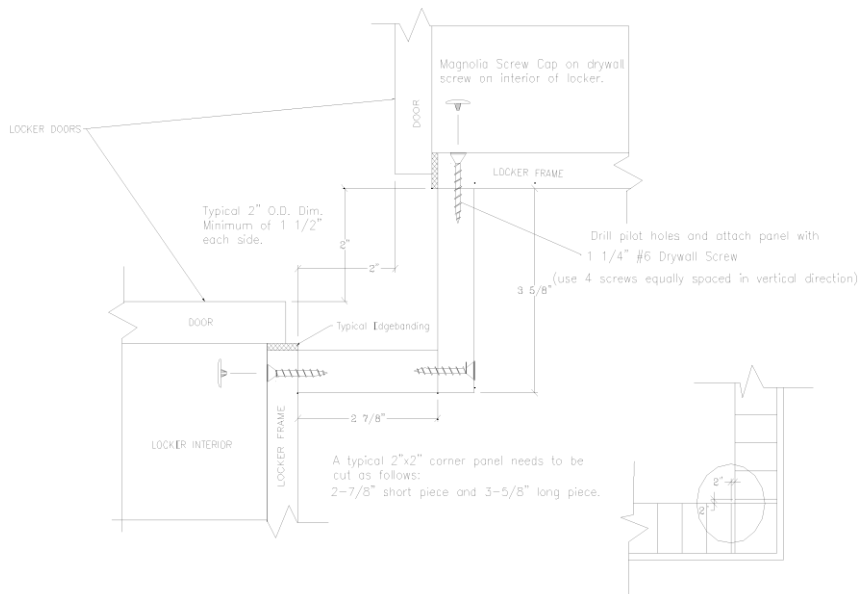

As appears on Locker Layout Plan

INSTALLATION & CARE INSTRUCTIONS CONT'D



VOID SPACE, CROWN MOLDING & SLOPE TOP:

Cover all void spaces in the corners with plywood or particle board (not included). If crown molding or slope top is included in your job, be sure to attach to the backing before installing. Place on top of lockers, securing through the interior of locker top into the thin edge of trim, or from the back, drilling through the backing of molding into locker frame. Avoid any face nailing if at all possible. Use great care in cutting 45-degree corners and splicing to ensure a professional looking installation.

NUMBER DISCS AND NAMEPLATES:

Attach with silicon or super glue only after lockers have been installed. Be sure of sequence before starting. Use the correct amount of glue so disc sits flush with the wood. Make sure number is parallel to floor (use level if necessary). Wipe off excess glue with soft cloth. To remove the plate, drill a small hole in to the plate and pull off with pliers.

KEYS AND TAGS:

Obtain key tags (not included, but are available through Fitness Finishes customer service) or another identification system to control key inventory. Number the same as corresponding lockers. Become familiar with your lock. Many keys can be duplicated at your local hardware store, and others are provided by Fitness Finishes. In any case, control key distribution, keeping one of each key with management. Locks, master keys and blanks are available for sale through Hollman, Inc. customer service.

CARE AND USE:

Clean plastic laminate lockers with 409 or another similar house hold cleaner. The outer portion of hardwood lockers may be cleaned and polished with pledge or another comparable product. Whatever the cleaning method, be careful with hardware. Finish may become discolored due to chemicals in cleaning products. Maintain lockers monthly to help keep them looking their best.

INSTALLATION & CARE INSTRUCTIONS CONT'D



Hinges:

Inspect each locker for function of lock. The hinges have a great effect on lock function and may have to be adjusted. There are 3 types of hinge adjustments, refer to the diagram for the effects of each.

Door Swing: Custom door hinges use 4 screws to hold the locker door and locker side wall together. The hinge has 125 degree swing and spring snap.

